

Please follow the below instructions for unloading trailers.

**Alliant Energy Center
1919 Alliant Energy Center Way
Madison, WI 53713**

Both trailers and semi-trailers will enter through Main Gate off of Rimrock Rd.

- 1) Upon entering the fairgrounds, trailers will be sent to the Welcoming Committee and trailer staging parking. Trailers will be welcomed in the Northeast Parking Lot.**
- 2) Vet Checks. Please have two copies of health papers with you. Vet will need to be able to look at animal tags in trailer.**
- 3) At this point, you will be assigned a barn door entry according to where your state is stalled. Here you will receive a stalling map.**
- 4) To help with flow and congestion, please unload everything from your trailer to your stalls. Do NOT start setting up your stall area until your trailer has been moved out of the barn and into trailer parking.

If stalling in the Pavilion 1 or Pavilion 2, different barn doors will be used.**
- 5) Once your trailer is unloaded, follow the map to trailer parking. Parking attendants will be on site directing traffic.**
- 6) Trailer parking for the week will be located on the far end of Quann Park, just north of tie outs.**

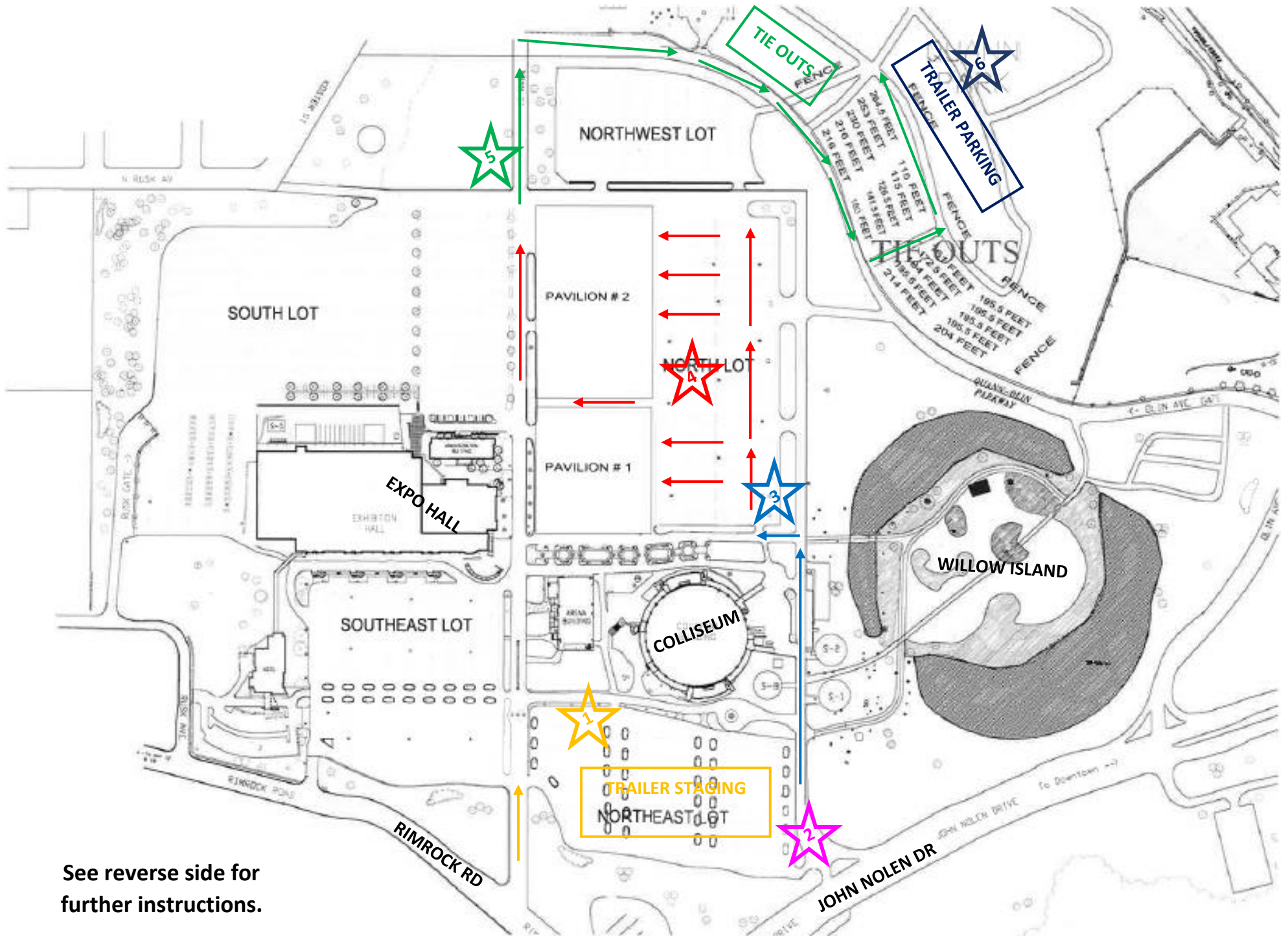

See reverse side for further instructions.